

SALES DRAWING

SALES DRAWING

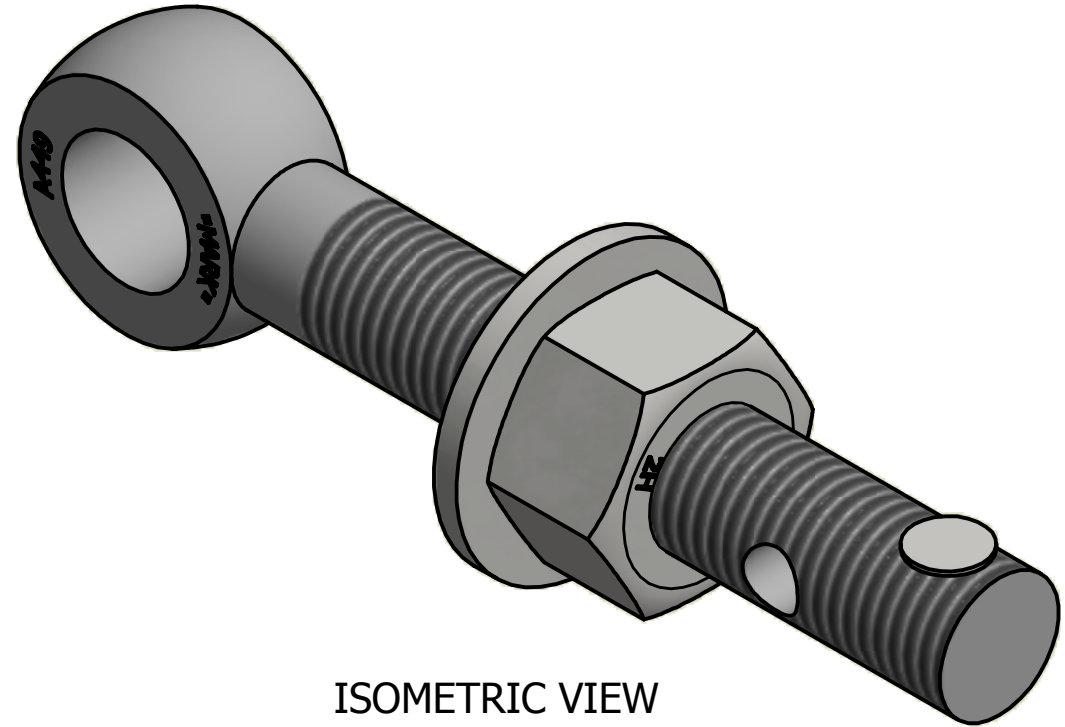
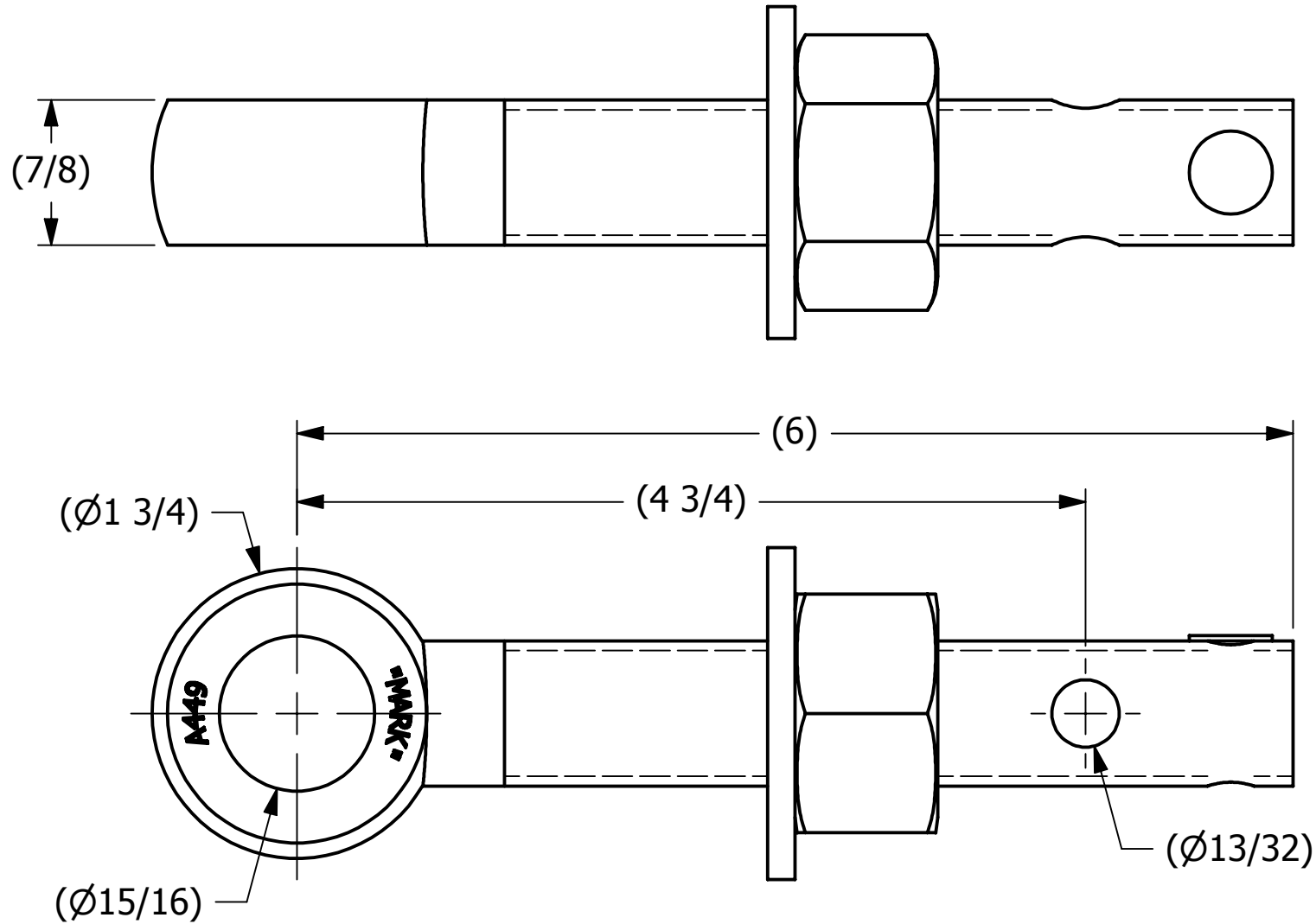

ISOMETRIC VIEW

- NOTES:
1. JET LUBE(PFPE GREASE) APPLIED TO WORKING THREAD AREA, THE BOTTOM FACE OF THE NUT, AND THE TOP FACE OF THE WASHER.
 2. BOLT STRENGTH EQUIVALENT TO SAE J429 GRADE 5.
 3. WASHER IS ASTM F436 HARDENED.

THIS PRINT, PROPERTY OF SALCO PRODUCTS INC., CONTAINS PROPRIETARY INFORMATION AND MUST NOT BE COPIED, REPRODUCED, OR USED DETRIMENTALLY TO OUR INTEREST.

UNLESS OTHERWISE SPECIFIED DIMENSIONAL TOLERANCES FRACTIONAL: $\pm 1/16$ X.XX: $\pm .03$ X.XXX: $\pm .015$ ANGULAR: $\pm 1^\circ$ DEBURR ALL SHARP EDGES. ALL MACHINED SURFACES TO HAVE A 125 RMS FINISH UNLESS NOTED OTHERWISE. THIRD ANGLE PROJECTION	DRAWN BY:	BRG	<div><div></div><div>SALCO PRODUCTS, INC.</div></div>		
	CHECKED BY:	CHL			
	PROTOTYPE BY:	BRG	PART NAME: EYEBOLT ASSEMBLY 7/8"X6"		
	PROTOTYPE DATE:	5/12/2008	MATERIAL: CARBON STEEL, ASTM A449 TYPE 1		
<div><div></div><div></div></div>	APPROVED FOR PRODUCTION BY:	CHL	PROJECT #: WAG0558	SHEET #: 1 OF 1	SCALE: 1:1
	PRODUCTION DATE:	9/21/2010	DRAWING #: B25271	PART #: EB786XHFTAG5L	